



**GROWING
HOME**

...

CORPORATE COMMUNITY IMPACT

As a Corporate Partner of Growing Home, you have the opportunity to engage in our mission and work in multiple ways to have the best impact on our South Side Chicago communities - in the way that fits your values and commitment options. We can't wait for you to get involved!

ABOUT GROWING HOME

We believe everyone deserves access to a good job and good food.

We are a non-profit urban farm & social enterprise serving Greater Englewood through our life-changing paid workforce development program & local, fresh affordable food and education programs.

Englewood & many communities of color in Chicago need investment. The effects of structural racism, historic segregation and systemic disinvestment continue to challenge our communities and neighborhoods today. As a means of restorative justice, we are committed to providing significant re-investment in Englewood and serve as a resource through our Food Access and Employment Training programs.

20 YEARS OF LEADERSHIP IN URBAN AGRICULTURE, EMPLOYMENT TRAINING & NONPROFIT SECTORS

WE PAY! ONLY A HANDFUL OF JOB PROGRAMS PAY THEIR PARTICIPANTS.

WE MAKE ORGANIC PRODUCE ACCESSIBLE & AFFORDABLE IN OUR NEIGHBORHOODS.

WE ARE A BLACK- & WOMEN-LED WITH MANY STAFF MEMBERS WHO ARE ALUMNI OF OUR PROGRAM.

WE ARE INCLUSIVE. WE HELP PEOPLE STAY OUT OF THE JUSTICE SYSTEM.

WE'RE THE FIRST AND ONLY HIGH-PRODUCTION USDA-CERTIFIED ORGANIC URBAN FARM IN CHICAGO!



GROUP VOLUNTEERING GROWING HOME

From volunteering on our farms to assisting with events or research projects, there are infinite ways to get involved with Growing Home for your organization.

growinghomeinc.org/volunteer

FARM VOLUNTEERING

Volunteer at Growing Home, a nonprofit USDA-certified organic farm that provides workforce development and fresh affordable vegetables in the Greater Englewood community of Chicago. Join us for on-going volunteer days on our farm!

Individuals or small groups can check our Volunteer Website Calendar for our most up-to-date volunteer opportunities at growinghomeinc.org/volunteer. If you have previous experience in farming, we'd love your expertise, advice and assistance. We can create a specialized schedule for your farm volunteering.

EVENT VOLUNTEERING

Throughout the year, Growing Home hosts community events, from 100-400+ attendees! This year, we are looking to have health awareness events at our farm stands, HarvestFest in October and WinterFest in December. We are always looking for Volunteer Groups to assist with tasks day before and day of.

PRO-BONO PROJECTS

Throughout the year, Growing Home hosts community events, from 100-400+ attendees! This year, we are looking to have health awareness events at our farm stands, HarvestFest in October and WinterFest in December. We are always looking for Volunteer Groups to assist with tasks day before and day of.



EMPLOYER PARTNER GROWING HOME

Hire Growing Home's qualified Production Assistants, mentor our alumni, or provide direct support to our trainees in the program. We will put you in touch with our Workforce Development Staff if you are interested.

BE A HIRING PARTNER OF OUR PROGRAMS

While our trainees spend 12 weeks on our farm and in our classroom learning transferable skills, we assist them in finding permanent, high-quality employment – and that could be at your work and industry! Growing Home staff only refers the most qualified of candidates for the job. We work with individuals to assess their experience, goals, and motivation to ensure that they are the right fit for your company.

As an Employer Partner of Growing Home, there are multiple benefits to you and your company. We provide follow-up support for you and our graduates throughout the life of their employment at your business.

BE A CLASSROOM OR RESOURCE CENTER PARTNER

Provide direct support to our trainees in the program by facilitating trainings and workshops in our Resource Center or for our paid Production Assistants in our Transitional Jobs Program. We are currently seeking workshops for:

- Mock Interview Sessions
- Customer Service Trainings or Financial Literacy
- Innovative Workforce Skills Workshops, like Career Jeopardy
- Employer Partner Guest Speakers from: Transportation, Healthcare, Warehouse, IT Construction/Installation Industries
- Certification Courses: CNA, Security and IT

We can host virtual and in-person trainings, ranging from one hour to multi-day. Thank you for your interest!



BE A COMMUNITY EVENT SUPPORTER

Support Growing Home's events! We invite you to sponsor or attend our events, provide in-kind donations, host a workshop or volunteer. Many ways to get involved!
growinghomeinc.org/events



THURSDAY FARM STAND SERIES

Third Thursday of Every Month, May-October, 11am-2pm

May 18: Grow with Us! Soil + Garden

June 15: Juneteenth Celebration

July 12: Grill & Chill

August 17: Back to School (TBD)

September 21: Steppin' into September

October 19: HarvestFest

This year we are excited to host our Thursday Farm Stand Series events! Every Thursday, Growing Home holds our fresh produce stand on site in Englewood, from 11am-5pm with Fresh Bites free samples and discounted produce. ****New this year!**** Every Third Thursday, we will host a larger community event featuring a partner workshop, resource tables, raffle prizes, family friendly activities and tours. Themes are shared above.

HarvestFest: Our longest-standing Farm Stand event, Growing Home hosts our annual HarvestFest in conjunction with one of our last farm stands of the year. This community-centric event features a local vendor market, kids activities, pumpkin decorating, free food box giveaway and more. Over 150 people attended this event in 2022, both local to Englewood and all over Chicago!

Want to get involved? We are looking for partners for the following:

- Sponsor an Entire Farm Stand Event: \$4,852
- Sponsor Produce, Prepared Meals or Item Donations: \$200-\$1200
- Provide a Workshop or Resource Table
- Volunteer or Attend with a Group

WE GROW WINTERFEST

December 2023 - Community Event @ The Peace Campus

Growing Home hosts our annual WinterFest to give back to our neighbors during the holiday season along with our We Grow Partners. With over 400 people in attendance, this community event is a huge success! Toys, raffles, warm winter gear, personal care items for kids and adults, fresh food - all for free - with fun holiday spirit.

JOIN OUR FUNDRAISERS!

Support Growing Home's special fundraisers! We invite you to sponsor, donate to or attend our Fundraiser events. All proceeds benefit our mission and work.

growinghomeinc.org/events



21ST ANNUAL BENEFIT

May 11, 2023 @ Salvage One in Chicago

Growing Home's largest donor and ambassador event of the year! This event features chef-prepared farm-to-table dishes, local beer and cocktails, live music, and a raffle of unique gifts. With over 300 in-person attendees from Growing Home's closest supporters to new partners, this event is one of the most fun of the year.



BACKYARD BARBECUE/ URBAN AG CRAWL

September 2023 - Fundraiser + Community Event

Growing Home will be hosting its 10th Annual Backyard Barbecue this year in conjunction with the Chicago Urban Ag Crawl with partner organizations! The BBQ event happens in Growing Home's actual backyard and features chef-prepared farm-to-table dishes, local beer and cocktails, live music, and a raffle of unique gifts for over 200 attendees.

ATTEND, SPONSOR OR DONATE TO EVENTS

LEARN MORE AT [GROWINGHOMEINC.ORG/EVENTS](https://growinghomeinc.org/events)

Event, Food, Drink and Decor sponsors and Silent Auction donors play a key role in allowing us to continue our important work. With your help, we host these two fundraisers that raise around \$300,000 annually of much-needed general operating funds. This fundraising allows us to grow over 40,000 items of local, organic produce and train 120 people who are eager to enter the workforce and sustain long-term employment. In return for your support, you'll have the opportunity to reach a diverse group of 20,000 influential supporters and you will receive a generous package of benefits.

For sponsorships, we have different tiers ranging from \$100-\$20,000 and can create a benefits package that best suits your company.

For item donations, you will receive recognition and benefits that align with the market value of your donated items.

BE A MISSION AMBASSADOR

Share Growing Home's story and be an advocate for Good Jobs and Good Food in Englewood!

growinghomeinc.org/about-us

HOST GROWING HOME FOR A SPEAKING EVENT

Host a speaker from Growing Home at your company to share our mission & learn from the best local urban agriculture and community development leaders!

- Engagements virtual and in-person, dependent on schedule
- Tailored to your audience
- Topics can include: Growing Home Mission, Nonprofit Leadership, Urban Farming & Sustainability, Food Security, Economic Opportunity & Workforce Development, Equity in Community Development
- Donation: \$350-500 for virtual | \$750-1000 for in-person

Contact Megan Morrison at mmorrison@growinghomeinc.org to set up an event.

JOIN OUR ASSOCIATE BOARD

Young professionals can also join our Associate Board! Acting as ambassadors of the organization, Associate Board members are super volunteers committed to supporting Growing Home and engaging the community through volunteering, fundraising, networking, and advocacy.

To learn more about the Associate Board, [click here](#)

To apply, please follow this link: bit.ly/GHAssociateBoard



BE A CORPORATE CIRCLE OF CHANGE MEMBER

Join an impactful and community-driven corporate and foundation donor circle.

growinghomeinc.org/circle-change

JOIN GROWING HOME'S CORPORATE CIRCLE OF CHANGE

Through our Circle of Change Donor Community, we highlight and honor the businesses, corporations, organizations and foundations who have greatly supported our mission and good jobs and good food in Greater Englewood. Members are highlighted in multiple ways throughout the year and are offered exclusive opportunities to engage deeper with Growing Home and our community.

For more information on the Corporate Circle of Change, please go to growinghomeinc.org/circle-change.

MEMBER LEVELS

Level 1 | \$5,000-\$14,999

Level 2 | \$15,000-\$24,999

Level 3 | \$25,000-\$49,999

Level 4 | \$50,000-\$99,999

Level 5 | \$100,000 and Above

MEMBER BENEFITS

From special events and invitations at Growing Home to media spotlights to our network of over 20,000 Subscribers, member benefits are fantastic.

See the complete list of benefits at growinghomeinc.org/corporate-change.



BE A FINANCIAL SUPPORTER

Your investment in Growing Home supports food access and employment access equity in our city.
growinghomeinc.org/donate

INVESTMENT IN THE SUSTAINABILITY OF OUR GROWING PROGRAMS

- Beginning in 2021, Growing Home increased participant enrollment into our paid job training program by 38%
- Since 2021, Growing Home committed to increasing food distribution in Englewood from 20% to 50%– in 2022 food distributed in and around Englewood was 70%
- With your support, we can ensure these expansions continue

CAPACITY SUPPORT

- Help us develop and refine skills, systems, structures and strategies that will ensure that we continue to meet the needs of our community: strategic planning, resource development, and staff development.

PROJECT SUPPORT

- Expand food access reach by investing in a mobile food buggy and pick-up truck
- Develop new space for growing food
- Renovate and Update current structures (i.e. Hoop Houses)

GENERAL OPERATING SUPPORT

- Support the working capital that nonprofits need to sustain their day-to-day operations

SPECIAL EVENT SUPPORT

- Sponsor our Special Events and Fundraisers throughout the year

NEW STAFF POSITION SUPPORT

- Support full-time staff for our new Computer and Job Resource Center, an experienced IT Specialist
- IT Specialist is responsible for technology, teaching classes, and IT needs for students and staff





PROGRAM SUPPORT: EMPLOYMENT TRAINING

Total: \$1,300,212

Trainee Salary: \$524,070

Program Staff: \$613,733

Alumni Engagement: \$13,720

Program Support: \$6,271

Trainee Equipment: \$8,266

PROGRAM SUPPORT: FOOD ACCESS

Total: \$517,981

Program Staff: \$323,606

Public Relations (Billboards, Ads): \$17,000

Equipment: \$31,339

Supplies (eg. Cooking Demo): \$32,300

PROJECT SUPPORT

Special Projects are un-budgeted and would be a great asset to our programs.

Food Buggy Pick-Up Truck: \$30,000

Hoop House Rewrap and Infrastructure Upgrades:
\$25,000-\$30,000

Outdoor Farming Infrastructure
Upgrade: \$5,000-\$10,000

Community Garden Support: \$5,000-\$10,000

CAPACITY SUPPORT

Growing Home seeks Planning/ Implementation Grant Support that will better position Growing Home to secure upcoming City of Chicago capital funding for our Wood Street South Development. With this project, we will expand our outdoor and indoor production space and job training and community resources.

Approx. \$750,000

Architectural, Legal, Consultation, Interest & Other

GENERAL OPERATING SUPPORT

Growing Home Operating Budget:
\$2,745,064

72% Program Expenses

17.6% Development/Fundraising

10.4% Administration

SPECIAL EVENT SUPPORT

Support our 21st Annual Benefit on May 11, 2023. Community Impact Sponsorship Levels available too.

Sponsorship Levels

Heirloom Tomato: \$20,000

Eggplant: \$15,000

Cauliflower: \$10,000

Asparagus: \$5,000

Spinach: \$2,500

Carrot: \$1,000

NEW STAFF POSITION SUPPORT

Resource Center IT Specialist
\$55,000





GROWING HOME

...

Farm and Training Center
5814 S. Wood St.
Chicago, IL 60636
(773) 434-7144

Administrative Office
6429 S. Honore St.
Chicago, IL 60636
(773) 549-1336

growinghomeinc.org  @growinghomeinc   @growinghome



GROWING HOME CAMPUS EXPANSION: PROJECT PREVIEW

Growing Home is a food equity, workforce development and social enterprise organization serving the larger Englewood community. Through USDA-certified organic urban farms, Growing Home operates innovate, paid training programs for Chicagoans with barriers to employment, including returning citizens – along with providing affordable & donated fresh food. Greater Englewood, where Growing Home is located, is an essential Chicago neighborhood with incredible leaders, people and culture. As recognized in the Invest South/West Initiatives, our neighborhood requires long-term investment to combat years of segregationist policies & systemic racism in Chicago. For 20 years and more, Growing Home has been a part of this change.

WHAT

We plan to develop 34,000+ square feet of new outdoor growing space and a 30,000+ square feet building that will house an expanded processing facility, a permanent storefront with fresh produce and prepared food products, a retail café, a teaching & commercial kitchen, a computer lab, offices and classroom space. The building itself will be a source of education and inspiration for different types of growing and sustainability as an innovative, effective and energy efficient building consistent with LEED certification.

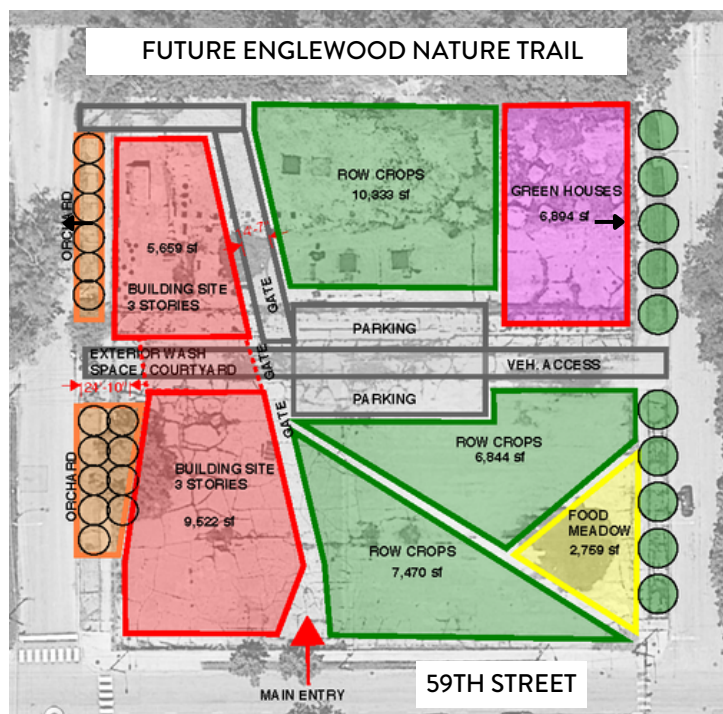

WHY

In 2015, Growing Home received a generous donation of a plot of land adjacent to our campus at the corner of 59th and Wood, across from Hermitage Park and next to the future Englewood Nature Trail. Currently vacant, we want to develop this space to:

INCREASE FOOD ACCESS by expanding production over 70%, meeting local demands for sales and donation that currently exceed our capacity

TRAIN MORE PEOPLE in essential job readiness, customer service & production skills, doubling our enrollment capacity in this vital employment and life skills program

STRENGTHEN ENTERPRISE OPPORTUNITIES for our participants, local food entrepreneurs and community with commercial kitchen & cafe along the major corridor of 59th Street

BUILD COMMUNITY CONNECTION with a teaching kitchen, public computer lab, meeting and event spaces, and indoor & outdoor cafe space – adjoining Hermitage Park and the future Englewood Nature Trail

INVEST IN GREEN SPACES & SUSTAINABILITY by reclaiming a concrete, vacant plot as a nurturing farm and education space and directly supporting the carbon draw-down goals of the Illinois Green Building Council

JOIN US

We seek the input and endorsement of every stakeholder concerned with food access, employment and development in the vital Greater Englewood area.

Contact our Executive Director, Janelle St. John at jstjohn@growinghomeinc.org or call us at 773-549-1336.





SPECIAL PROJECT: GROWING HOME FARM ENTERPRISE EXPANSION PLAN

INCREASE FOOD ACCESS

- An additional large outdoor farm space and new indoor agriculture building in our currently vacant lot at 1824 S. Honore will allow us to increase food production & outreach by over 70%
- Building will include a Retail Store, transforming our farm stand into an actual farm store/cafe.
- Expanded space means expanded produce partnerships. In 2022, we have already received requests from partnering organizations that far exceed our current capacity.

TRAIN MORE PEOPLE

- Increasing farm space allows us to increase the number of people employed and trained at Growing Home, impacting individuals, their families, and our community.
- A large and flexible classroom or group meeting space, offices for one-on-one and workshops
- Heated, indoor growing spaces will allow us to train year-round & allow 12-month food production
- Diversify our training through "higher tech" indoor agriculture, e.g. hydroponics & microgreens

INCREASE COMMUNITY OUTREACH

- A Training & Commercial Kitchen will help increase demand for fresh produce and allow us to do more workshops to share in easy and healthy food preparation.
- Indoor event space for community meetings, events and workshops

COST ESTIMATES

Growing Home primarily seeks Consultation Support to secure necessary funding for our Wood Street South Development. We estimate this to be \$750,000 to cover Architectural, Legal, Consultation and related services.

In total, this expansion project will cost \$10M-14M pending final architectural drawings and construction estimates.

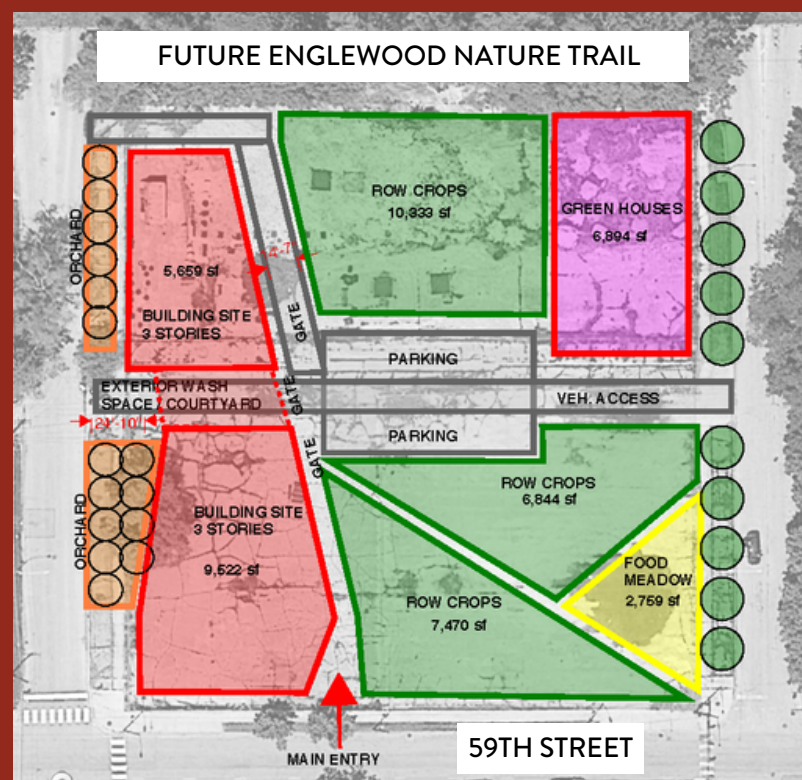



SPECIAL PROJECT: FOOD BUGGY & PICK-UP TRUCK

DESIGNED AS MOBILE FARM STAND & WORKSHOP SPACE

- Kitchen space with stove, sink, refrigeration, countertop for prepping meals & selling fresh organic produce
- Cooking space can convert into tabletop for demos & educational workshops
- Easy viewing area for workshop attendees

BRINGS NUTRITIONAL, HEALTHY OPTIONS INTO OUR COMMUNITIES

- Small & Compact; Able to hitch on back of standard pick-up truck
- Used in indoor and outdoor spaces: Backyards, Organization Parking Lots & Basketball Courts, Gyms, Block Parties
- Create pop-up stands and workshops at Community Events

ENVIRONMENTALLY SUSTAINABLE

- Less carbon footprint than a food truck
- Safer and cleaner environment for customers and workshop attendees

COST ESTIMATES

Through our research, we estimate a food buggy with all of the necessary equipment to cost \$25,000. We would also need a standard pickup truck to pull the food buggy and serve as a farm vehicle to hold and deliver produce, estimated cost is \$ 30,000 (used).





PROGRAM SUPPORT: EMPLOYMENT TRAINING

Total: \$1,300,212

Trainee Salary: \$524,070

Program Staff: \$613,733

Alumni Engagement: \$13,720

Program Support: \$6,271

Trainee Equipment: \$8,266

PROGRAM SUPPORT: FOOD ACCESS

Total: \$517,981

Program Staff: \$323,606

Public Relations (Billboards, Ads): \$17,000

Equipment: \$31,339

Supplies (eg. Cooking Demo): \$32,300

SPECIAL PROJECT SUPPORT: FARM EXPANSION

Growing Home seeks funding support for our upcoming Capital Campaign project: our Growing Home Farm Enterprise Expansion Project. See Following Page for more details.

At this time, we are seeking Consultation Support to continue necessary planning work to secure upcoming grant support. We estimate this to be \$750,000 to cover Architectural, Legal, Consultation and related services.

GENERAL OPERATING SUPPORT

Growing Home Operating Budget:
\$2,694,187

75% Program Expenses
14% Development/Fundraising
12% Administration

SPECIAL EVENT SUPPORT

Support our 9th Annual Backyard BBQ & Urban Ag Crawl on September 11, 2022. To see full Sponsorship Packet, [click here](#).

Sponsorship Levels

Platinum: \$25K-30K

Gold: \$15K-25K

Silver: \$10K

Bronze: \$5K

Copper: \$2500

Friend: \$500-\$1000

SPECIAL EVENT SUPPORT

Support our 3rd Annual Share the Love Winterfest Event with a Sponsorship or Donations.

You can sign up for in-kind donations on behalf of your company [here](#).



VOLUNTEERS WANTED!

Do you love working with your hands? Are you interested in learning about Chicago's thriving urban agriculture community?

Volunteer at Growing Home, a nonprofit USDA-certified organic farm that provides workforce development and fresh affordable vegetables in the Greater Englewood community of Chicago. Join us for a day of fun and impactful work on our farms!

TASKS INCLUDE:

Harvesting, Weeding, Planting,
Composting, Site Beautification,
Building Garden Beds
(Tasks depend on the time of season)

SCHEDULE A GROUP

If you're interested in volunteering with a group or corporate team, please contact LaQuandra Fair at: volunteer@growinghomeinc.org (773) 549-1336.

SIGN UP NOW!

growinghomeinc.org/volunteer



Shift Sign-Up



Monthly Emails
Sign-Up



HOST YOUR CORPORATE VOLUNTEER DAY WITH GROWING HOME

A Corporate Volunteer Day with Growing Home is a unique team-building experience to learn, grow and share in making a tangible difference in Chicago communities. Come Grow with Us!



FARM VOLUNTEER HALF DAY -\$5,000-

A 4-hour experience on our farms fit to your schedule and group number. An experienced Growing Home leader will teach you the skills you need to accomplish important projects on our farm, including harvesting and processing or building in our community garden. Tour & lunch is included.



FARM VOLUNTEER FULL DAY -\$7,500-

A full day experience for a corporate team that wants a full team-building day! We may work on larger projects such as constructing boxes for our community garden site, assisting with our farm work or other essential projects. Tour, lunch & snack included.



HOST AN EVENT OR RETREAT -\$10,000-

Host your staff retreat, your leadership training or a networking event on our site! Catered lunch and/or refreshments, a live cooking demo, a special tour of Growing Home and a take-home farm gift for each attendee.



GROW-A-THON AT THE OFFICE -PRICELESS-

Host your own fundraiser for Growing Home! From raising funds to support our essential programs or hosting a toy or warm winter gear drive for one of our community events, you can volunteer your time without even leaving your office! We can provide any marketing materials you may need to fit the fundraiser.



BECOMING A GROWING HOME EMPLOYER PARTNER

**HELP YOUR
TEAM GROW
WITH
QUALIFIED,
EXPERIENCED,
READY-TO-
WORK
CANDIDATES.**

Growing Home is an organic urban farm and workforce development center that trains up to 80 Production Assistants each year in planting, harvesting, maintaining and selling organic produce, all transferable essential skills.

While Production Assistants spend 12 weeks on our farm and in our classroom, we assist them in finding permanent, high-quality employment. Our job seekers are pre-screened for the employer's qualifications and are ready to work.

Join us by becoming an employer partner today.

CULTIVATE YOUR NEXT GREAT EMPLOYEE

Growing Home staff only refers the most qualified of candidates for the job. We work with individuals to assess their experience, goals, and motivation to ensure that they are the right fit for your company.

As employees of our business, Production Assistants learn a variety of skills, including:

- Attention to detail & quality control
- Knowledge of organic produce
- Multitasking and prioritization
- Pace and efficiency
- Teamwork

In addition, Production Assistants learn a multitude of skills through our structured job readiness curriculum:

- Conflict management
- Customer service and hospitality
- ServSafe Food Handler's certificate
- Time management and timeliness

BENEFITS TO YOU

As an Employer Partner of Growing Home, there are multiple benefits to you and your company. We provide follow-up support for you and our graduates throughout the life of their employment at your business. As a part of this, you will receive:

- Assistance with tax credits
- 30, 60, 90 day check-ins
- Continued Wrap Around Support
- Periodic phone calls with managers
- Interview Scheduling for multiple hires



JOIN OTHER GREAT COMPANIES

- Local Foods
- Kitchfix
- Whole Foods
- Chicago Scaffolding, Inc.
- Pactiv



GROWING HOME SPEAKING EVENTS & WORKSHOPS

We are a nonprofit organic urban farm and workforce development program located in the Englewood neighborhood of Chicago. Host a speaker from Growing Home at your company to share our mission & learn from the best local urban agriculture and community development leaders!

INFORMATION



Companies, Organizations, Events



Weekdays & Select Weekends
Schedule min. 2 weeks ahead



8am-6pm, Flexible



Online, at your site or at our farms:
5814 S. Wood Street, Chicago

**Suggested Donation/
Honorarium**

\$350-\$500 Virtual
\$750-\$1,000 In-Person

TOPICS

Here's a sample topics we have spoken about in the past.
We can tailor the topic to your audience and interest.

GROWING HOME MISSION & VISION

URBAN FARMING & SUSTAINABILITY

NONPROFIT LEADERSHIP

FOOD JUSTICE/ FOOD ACCESS

ECONOMIC OPPORTUNITY & EQUITY

COOKING & WELLNESS



ASSOCIATE BOARD

WE BELIEVE **EVERYONE** DESERVES A GOOD JOB & GOOD FOOD

...

The Associate Board is a group of super volunteers committed to supporting Growing Home, a nonprofit organic farm that provides employment training and organic produce in the Greater Englewood community of Chicago.

These young professionals assist with program initiatives and fundraising events including our Annual Benefit & Backyard BBQ, a popular small plates gathering. Associate Board members also volunteer on our farms and serve as ambassadors for the organization.

Meetings are held bi-monthly on Tuesdays virtually and in-person. We also hold committee meetings throughout the year.

Open to young professionals, 18-35 yrs.



LEARN MORE: growinghomeinc.org

APPLY: <https://bit.ly/GHAssociateBoard>

SCAN TO APPLY NOW!

